

ADDITIONS AND RENOVATIONS TO THE PAN-AM POOL WINNIPEG MANITOBA

PAN AMERICAN GAMES SOCIETY (WPG 1999)
LA SOCIEDAD PARA LOS JUEGOS PANAMERICANOS (WPG 1999)
SOCIETE DES JEUX PANAMERICAINS (WPG 1999) INC.

DRAWING LIST

ARCHITECTURAL

- A1.1 KEY PLAN
- A2.1 BASEMENT PLAN
- A2.2 GROUND FLOOR PLAN
- A2.3 UPPER LOBBY PLAN
- A3.1 WEST ELEVATION, NORTH ELEVATION
- A4.1 SOUTH ELEVATION, BUILDING SECTION
- A5.1 SECTIONS - DETAILS
- A5.2 SECTIONS - DETAILS
- A5.3 TIMING BOOTH DETAILS / MILLWORK DETAILS AND SECTIONS
- A5.4 SECTION THRU WARM UP TANK / DETAILS
- A5.5 RAMP ELEVATION
- A6.2 GROUND FLOOR REFLECTED CEILING PLAN
- A6.3 REFLECTED CEILING PLAN - EAST
- A8.1 INTERIOR ELEVATIONS / KITCHEN DETAILS

STRUCTURAL

- S2.1 FOUNDATION AND MAIN FLOOR FRAMING PLANS
- S2.2 BASEMENT, ROOF AND SECOND FLOOR FRAMING PLANS
- S5.1 SECTIONS AND DETAILS

MECHANICAL

- MP2.1 BASEMENT FLOOR PLAN PLUMBING
- MP2.2 GROUND FLOOR PLAN PLUMBING
- MH2.1 MECHANICAL ROOM, SECTIONS AND AIR CODITIONING
- MH2.1 GROUND FLOOR AND PART UPPER LEVEL H.V.A.C.
- MH2.3 MECHANICAL ROOM, DETAILS AND SCHEMATICS
- MH2.4 GROUND FLOOR PLAN HEATING
- M5-0 MECHANICAL SCHEDULES DETAILS AND LEGEND

ELECTRICAL

- EP2.2 PARTIAL MAIN FLOOR PLAN POWER AND SYSTEMS
- E2.1 BASEMENT PLAN - ELECTRICAL & MOTOR SCHEDULE
- E2.3 UPPER LOBBY PLAN - ELECTRICAL & SINGLE LINE
- EL2.2 PARTIAL FLOOR PLAN LIGHTING

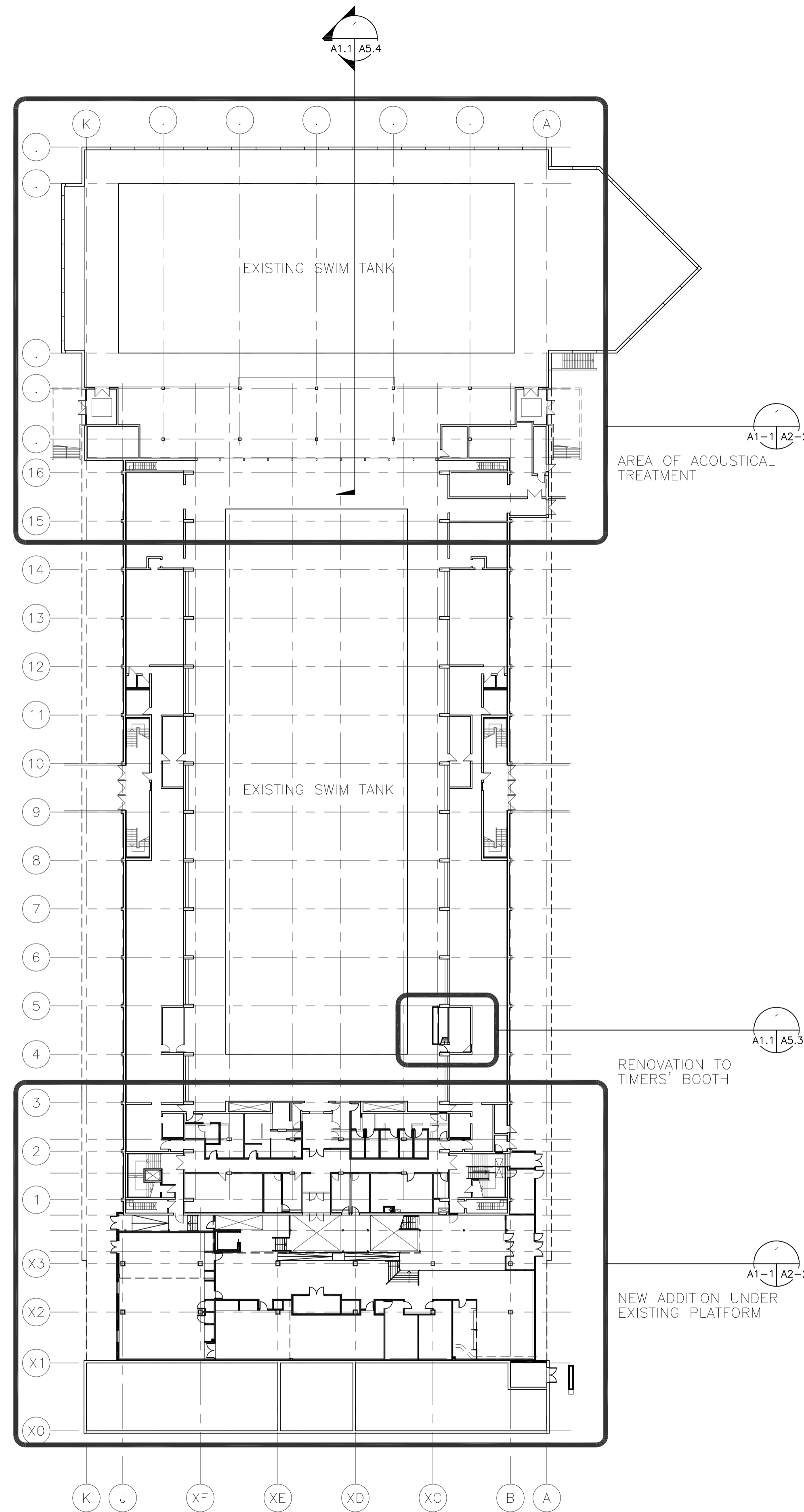

1 KEY PLAN - POOL LEVEL
0 20 40 60 80 100 1" = 30'

WALL TYPES	ROOF TYPES
<p>W1 1/2" G.W.B. (+1/2" CEMENT BOARD) 1/2" G.W.B. 3 5/8" STEEL STUDS @ 16" O/C BATT INSULATION 1/2" G.W.B. (+1/2" CEMENT BOARD) NOTE: SIDE WITH DOUBLE LAYER TO BE LAMINATED, VERTICAL JOINTS STAGGERED.</p> <p>(*) CEMENT BOARD UDER CERAMIC TILES</p> <p>W2 2 LAYERS 1/2" TYPE X G.W.B. 3 5/8" STEEL STUDS @ 16" O/C BATT INSULATION 2 LAYERS 1/2" TYPE X G.W.B.</p> <p>W3 8" CONCRETE BLOCK NOTE: PROVIDE MIXTURE OF TEXTURED AND COLOURED BLOCK FOR UPPER TWO LEVELS.</p> <p>W4 1/2" G.W.B. 3 5/8" STEEL STUDS @ 16" O/C 1/2" G.W.B.</p> <p>W5 1/2" G.W.B. 3 5/8" STEEL STUDS @ 16" O/C BATT INSULATION 1/2" G.W.B.</p> <p>W6 EXISTING CONCRETE 3 5/8" STEEL STUDS @ 24" O/C BATT INSULATION POLY V.B. 1/2" G.W.B.</p> <p>W7 PREFINISHED STEEL SIDING GALV. FURRING / GIRT SYSTEM 2" RIGID INSULATION BITUMINOUS AIR V.B. 1/2" BACKING BOARD 3 5/8" STEEL STUD @ 16" O/C BATT INSULATION 1/2" G.W.B.</p> <p>W8 1/2" G.W.B. 3 5/8" STEEL STUDS @ 16" O/C 1/2" WATER PROOF DRYWALL CEMENT BOARD</p> <p>W9 EXTERIOR ALUM. WINDOW SYSTEM NOTE: INSULATED SPANDREL PANELS AS INDICATED</p> <p>W10 INTERIOR ALUM. GLAZED SYSTEM</p> <p>W11 CEMENTOUS FINISH ON 1/2" CEMENT BOARD BACKING 2" RIGID INSULATION BITUMINOUS AIR V.B. 8" CONCRETE 2 1/2" STEEL STUD BATT INSULATION 1/2" G.W.B.</p> <p>W12 PREFINISHED ALUMINUM FLASHING ROOFING MEMBRANE 1/2" PLYWOOD 6" STEEL STUD @ 16" O/C BATT INSULATION POLY V.B. 1/2" G.W.B. NOTE: STRUCTURAL REINFORCING AS REQUIRED.</p> <p>W13 1/2" G.W.B. CONTINUOUS POLY V.B. 2 1/2" STEEL STUD BATT INSULATION 8" REINFORCED CONCRETE 2" RIGID INSULATION</p> <p>W14 EXISTING WALL 2 1/2" STEEL STUD 1/2" G.W.B.</p> <p>W15 EXISTING 8" CONC. BLOCK WALL</p> <p>W16 EXISTING REINFORCED CONCRETE NOTE: PATCH FURRING AND PLASTER AS REQUIRED.</p>	<p>R1 PAVERS EPDM OR 4-PLY B.U.R. 2 1/2" RIGID POLYISO INSULATION VAPOUR BARRIER EXISTING CONCRETE</p> <p>R2 EPDM OR 4-PLY B.U.R. 2 1/2" RIGID POLYISO INSULATION VAPOUR BARRIER 1/2" G.W.B. 1 1/2" STEEL DECK STRUCTURAL STEEL SEE STRUCTURAL</p>

No.	Description	Date (d/m/y)	Drawn	Checked
Revisions/Issuance (Read Up)				
Initialed By				
Designed By	AC			
Drawn By	PPB			
Checked By	AC			
Approved By	JW			

Man-Shield
CONSTRUCTION INC.
205-698 CORYDON AVE
WINNIPEG, MANITOBA
R3M 0V9
(204) 453-9177

Smith Carter Architects
and Engineers Incorporated
1601 Buffalo Place
Winnipeg, Manitoba
Canada, R3T 3K7
Tel. (204) 477-1260
Fax. (204) 477-6346

Smith Carter
Architects
Engineers
Planners
Interior Designers

ADDITIONS AND RENOVATIONS
TO THE PAN-AM POOL
WINNIPEG MANITOBA

Sheet Title	KEY PLAN
Scales	AS NOTED
Date	JAN 13, 1998
File Number	97126
Sheet Number	A1.1

